

Mini Multi Angle

P/N: 8100350

Tool Features

The Magswitch line of Mini Multi Angle workholding magnets offer you more angles in one product than any other magnetic angles. If you're tired of Mini angle magnets that claim they shut off, but really don't, then you'll love Magswitch. Magswitch Mini angles are hassle free. They stay clean for years of use. Once you use Magswitch Mini Angles, you will never settle for anything less!



WARNING!
DO NOT OPERATE UNLESS IN
CONTACT WITH FERROUS TARGET

Specifications

Max Breakaway *	400 lbs	40 kg
Full Saturation Thickness		
Max Safe Shear *	6 lbs	2.7 kg
Net Weight	0.4 lbs	0.2 kg
Overall Height	65 mm	
Magnetic Pole Footprint	32 mm x 72 mm	

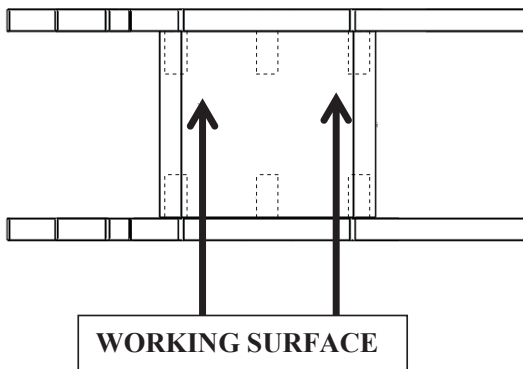

* Max Breakaway determined in laboratory environment on 2" thick SAE1018 Steel with surface roughness 63 micro inches. Many factors contribute to the actual breakaway force in each application. Always test the magswitch in each application before deployment. Refer to the magswitch information booklet for more information.

Mini Multi Angle

P/N: 8100350

Drawings

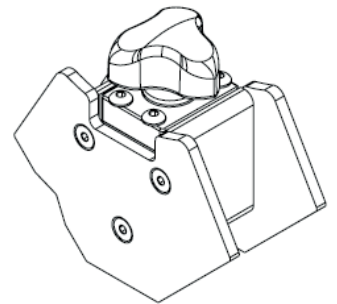
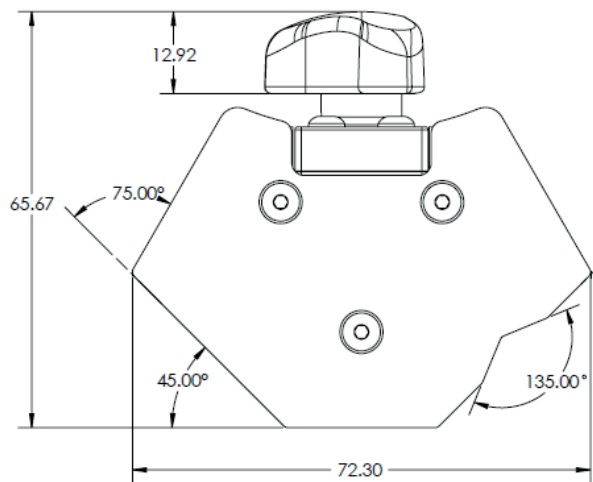
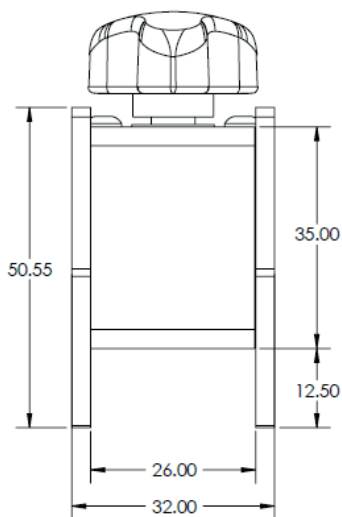

Mini Multi Angle

P/N: 8100350

Breakaway Data

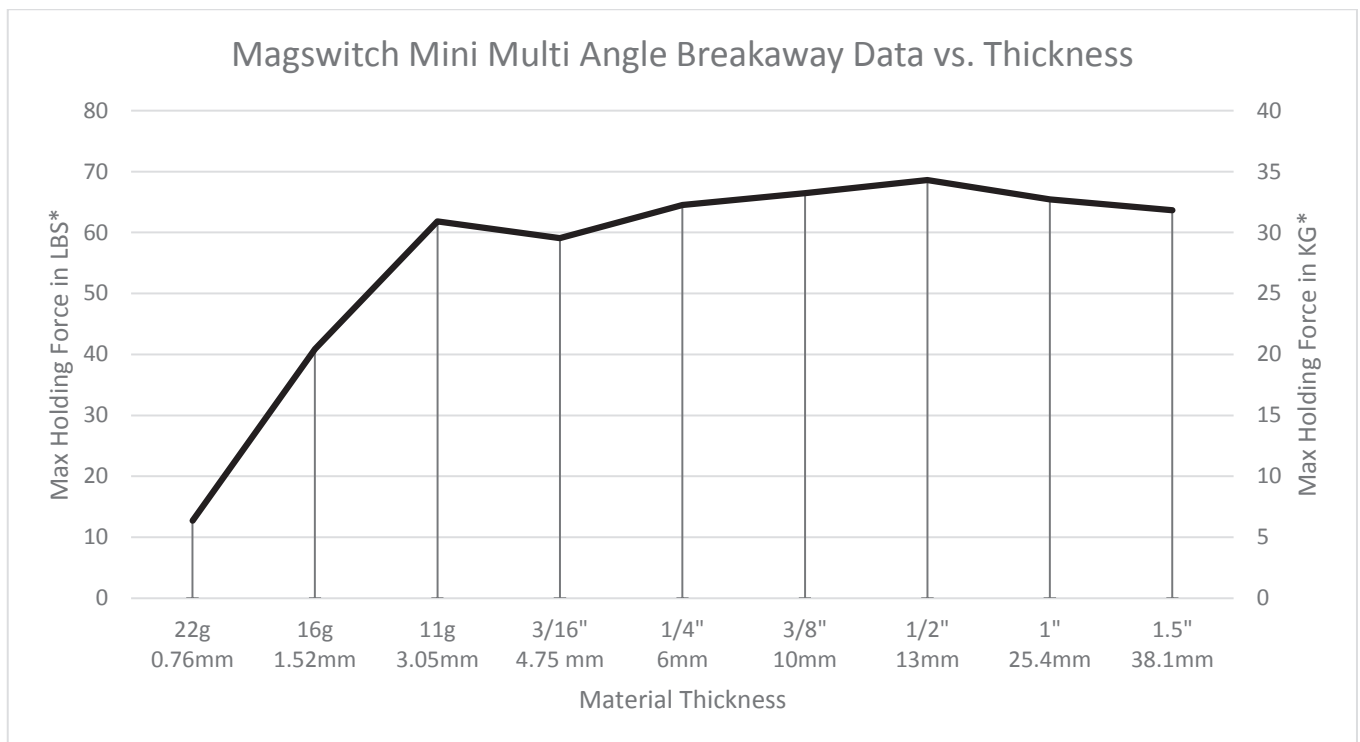

* Max Breakaway determined in laboratory environment on 2" thick SAE1018 Steel with surface roughness 63 micro inches. Many factors contribute to the actual breakaway force in each application. Always test the magswitch in each application before deployment. Refer to the magswitch information booklet for more information.

Mini Angle

P/N: 8100352

Tool Features

The Magswitch line of Mini Multi Angle workholding magnets offer you more angles in one product than any other magnetic angles. If you're tired of Mini angle magnets that claim they shut off, but really don't, then you'll love Magswitch. Magswitch Mini angles are hassle free. They stay clean for years of use. Once you use Magswitch Mini Angles, you will never settle for anything less!

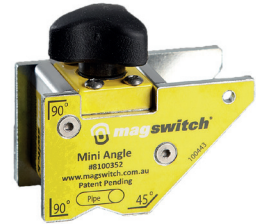

WARNING!
DO NOT OPERATE UNLESS IN
CONTACT WITH FERROUS TARGET

Specifications

Max Breakaway *	90 lbs	40 kg
Full Saturation Thickness	11 g	3.05 mm
Max Safe Shear *	6 lbs	2.7 kg
Net Weight	0.4 lbs	0.2 kg
Overall Height	55 mm	
Magnetic Pole Footprint	59.5 mm x 32 mm	

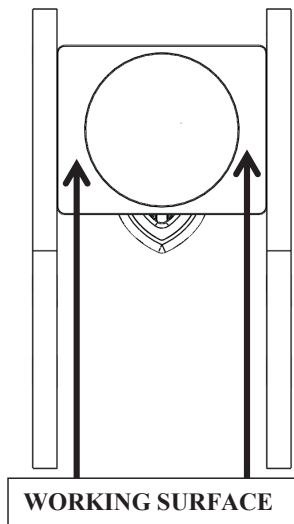

* Max Breakaway determined in laboratory environment on 2" thick SAE1018 Steel with surface roughness 63 micro inches. Many factors contribute to the actual breakaway force in each application. Always test the magswitch in each application before deployment. Refer to the magswitch information booklet for more information.

MINI ANGLE
8100352

Doc Num 01

Magswitch Technology Europe GmbH
cs@magswitch.com | www.magswitch.com

Subject to technical and color changes. No liability for errors and misprints assumed. © Magswitch Technology Europe 2024

Mini Angle

P/N: 8100352

Drawings

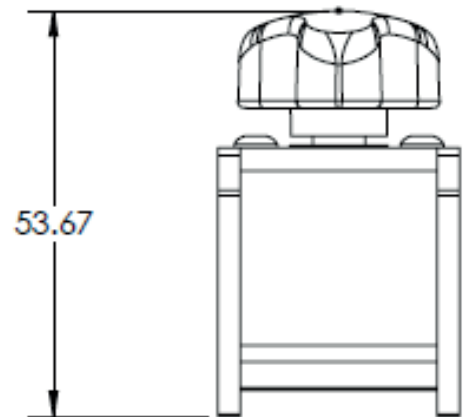
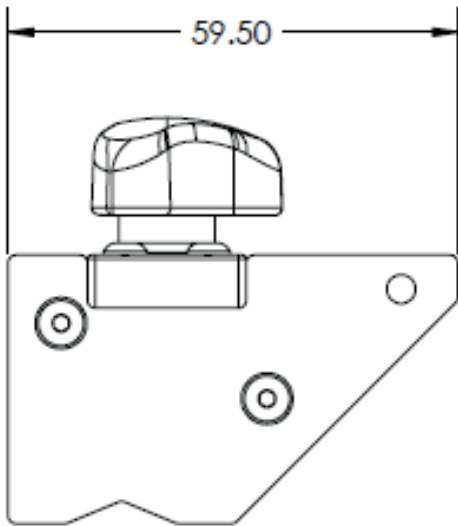
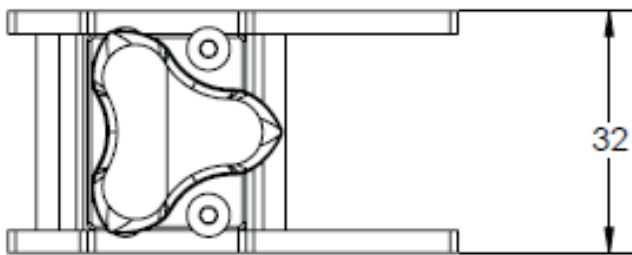

Mini Angle

P/N: 8100352

Breakaway Data

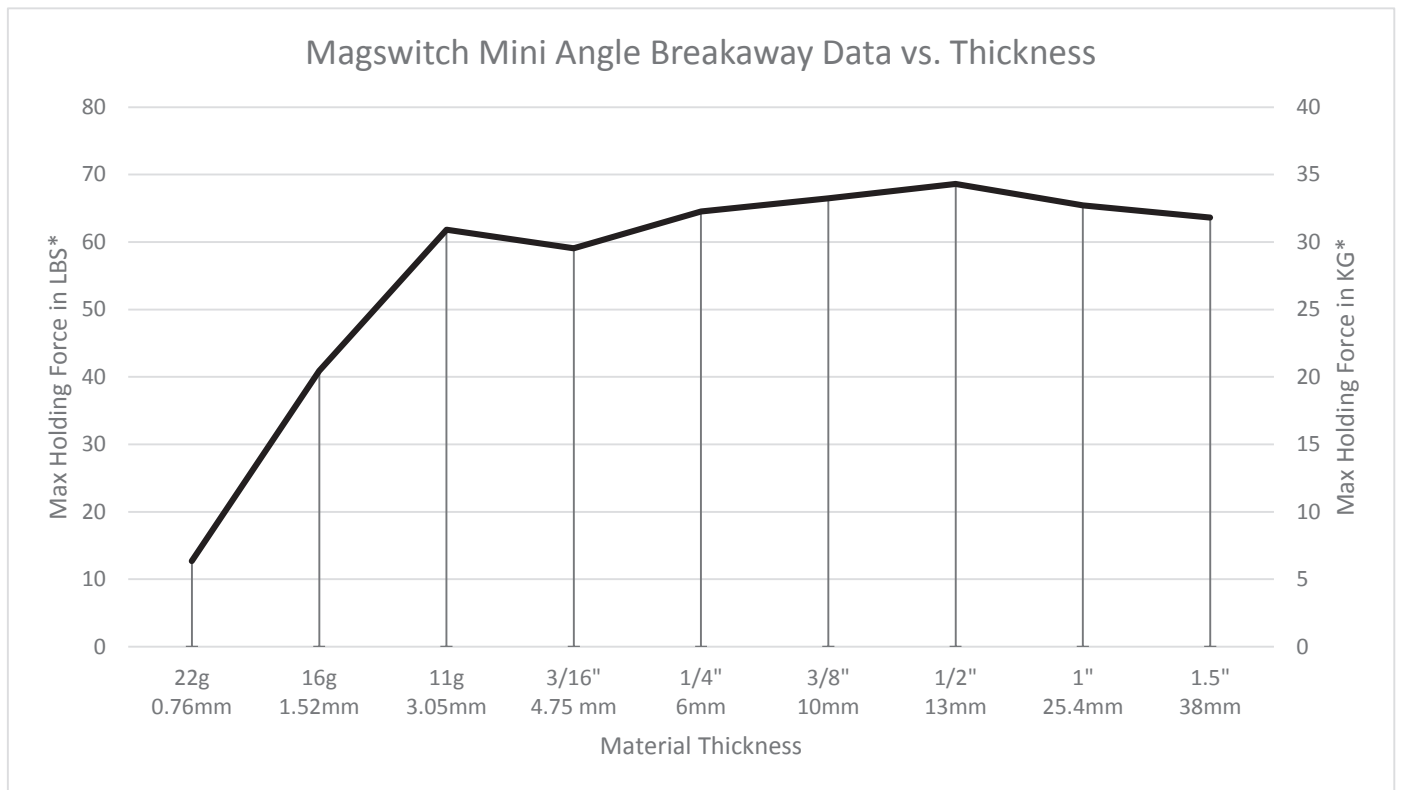

* Max Breakaway determined in laboratory environment on 2" thick SAE1018 Steel with surface roughness 63 micro inches. Many factors contribute to the actual breakaway force in each application. Always test the magswitch in each application before deployment. Refer to the magswitch information booklet for more information.