

Pivot Angle 150 Max

P/N: 81001215

Tool Features

The Magswitch Pivot Angle offers a range of angles from 0 to 270 degrees. Each axis features a Magswitch with a 182lbs (82.6kg) hold capability. A single pivot point is located on the elbow. The elbow joint locks and unlocks quickly with a thumb screw. The dial on the elbow features indicators every 9 degrees. On each axis a Magswitch magnetic tool is exposed on a side to enable the tool to secure to a table or wall, while simultaneously holding the work piece. Perfect for repetitive work on uncommon angles.



WARNING!
DO NOT OPERATE UNLESS IN
CONTACT WITH FERROUS TARGET

Specifications

Maximum Breakaway Force ^{1,2,4}	182 lbs		83 kg	
Maximum Shear ^{1,2,4}	25.3 lbs		11 kg	
Full Saturation Thickness	3/16 in		4.8 mm	
Overall Height (Max)	2.1 in		53.4 mm	
Overall Length	8.5 in		215.5 mm	
Overall Width	2.6 in		66.0 mm	
Net Weight	3.3 lbs		1.5 kg	
Magnetic Pole Footprint	1.0 x 2.1 in		26.4 x 54 mm	

Material Thickness - mm (in)	1.0 (0.039)	2.0 (0.079)	3.0 (0.118)	4.0 (0.157)	5.0 (0.197)	6.0 (0.236)	50.0 (1.969)
Maximum Force ⁴ - kg (lbs)	18.3 (40)	38.7 (85)	62.7 (138)	76.0 (168)	82.5 (182)	82.6 (182)	82.6 (182)

1. Determined in laboratory environment on 2" thick SAE1018 Steel with surface roughness 63 micro inches with optimized pole shoes. Many factors contribute to the actual breakaway force and safe working load in each application. Consult a Magswitch Applications Engineer and test the Magswitch in each application before deployment.

2. All data applies to unit with flat pole shoes installed.

3. Values may vary by +/- 5%.

4. Maximum forces listed above are not safe lifting forces. Designer must take into account safety factor when specifying tool. Magswitch recommends SWL = 5:1 for most applications.

Pivot Angle 150 Max

P/N: 81001215

Drawings

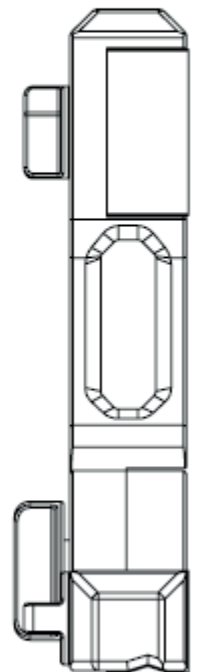
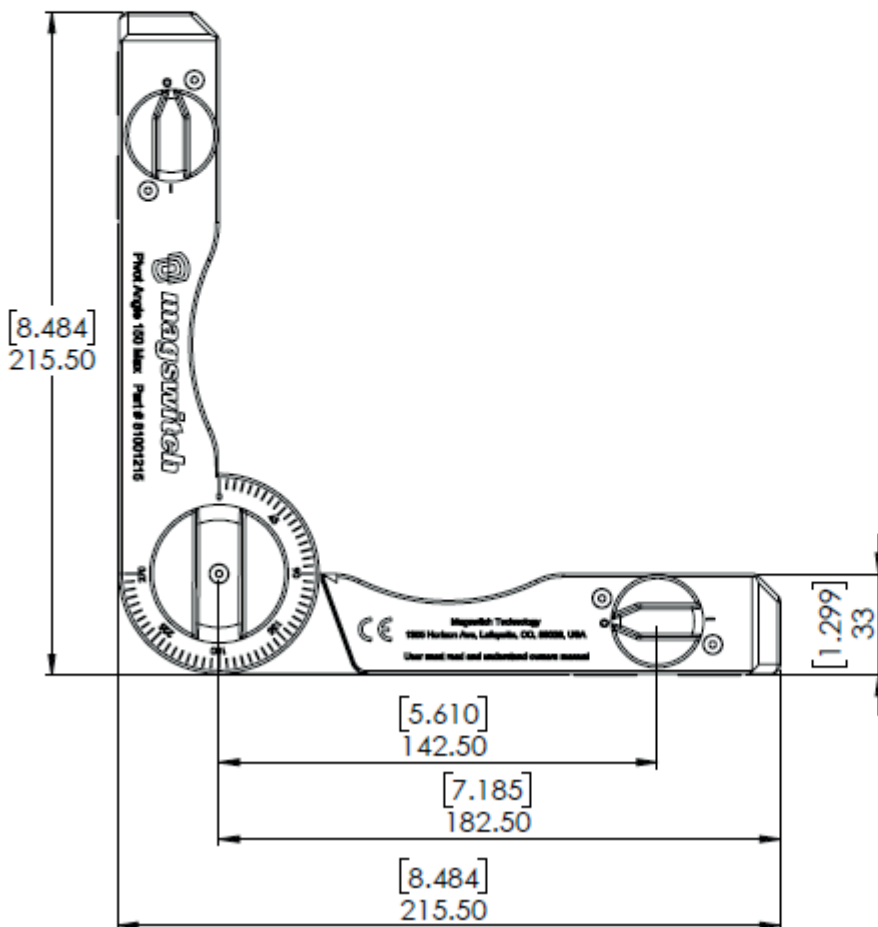
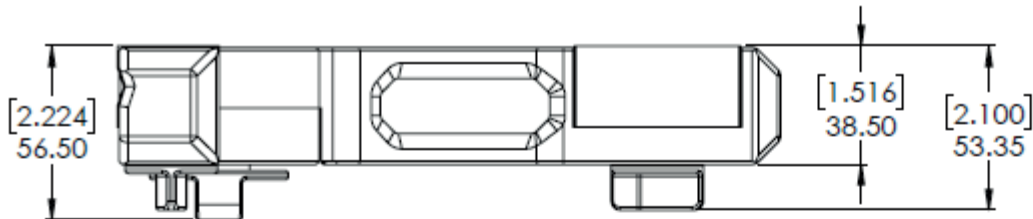

Pivot Angle 150 Mini

P/N: 81001269

Tool Features

The Magswitch Pivot Angle offers a range of angles from 0 to 270 degrees. Each axis features a Magswitch with a 182lbs (82.6kg) hold capability. A single pivot point is located on the elbow. The elbow joint locks and unlocks quickly with a thumb screw. The dial on the elbow features indicators every 9 degrees. On each axis a Magswitch magnetic tool is exposed on a side to enable the tool to secure to a table or wall, while simultaneously holding the work piece. Perfect for repetitive work on uncommon angles.



WARNING!
DO NOT OPERATE UNLESS IN
CONTACT WITH FERROUS TARGET

Specifications

Maximum Breakaway Force ^{1,2,4}	182 lbs		83 kg	
Maximum Shear ^{1,2,4}	25.3 lbs		11 kg	
Full Saturation Thickness	3/16 in		4.8 mm	
Overall Height (Max)	2.1 in		53.4 mm	
Overall Length	6.1 in		155.5 mm	
Overall Width	2.6 in		66.0 mm	
Net Weight	3 lbs		1 kg	
Magnetic Pole Footprint	1.0 x 2.1 in		26.4 x 54 mm	

Material Thickness - mm (in)	1.0 (0.039)	2.0 (0.079)	3.0 (0.118)	4.0 (0.157)	5.0 (0.197)	6.0 (0.236)	50.0 (1.969)
Maximum Force ⁴ - kg (lbs)	18.3 (40)	38.7 (85)	62.7 (138)	76.0 (168)	82.5 (182)	82.6 (182)	82.6 (182)

1. Determined in laboratory environment on 2" thick SAE1018 Steel with surface roughness 63 micro inches with optimized pole shoes. Many factors contribute to the actual breakaway force and safe working load in each application. Consult a Magswitch Applications Engineer and test the Magswitch in each application before deployment.

2. All data applies to unit with flat pole shoes installed.

3. Values may vary by +/- 5%.

4. Maximum forces listed above are not safe lifting forces. Designer must take into account safety factor when specifying tool. Magswitch recommends SWL = 5:1 for most applications.

Pivot Angle 150 Mini

P/N: 81001269

Drawings

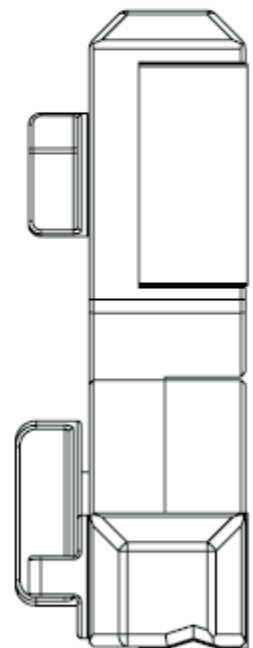
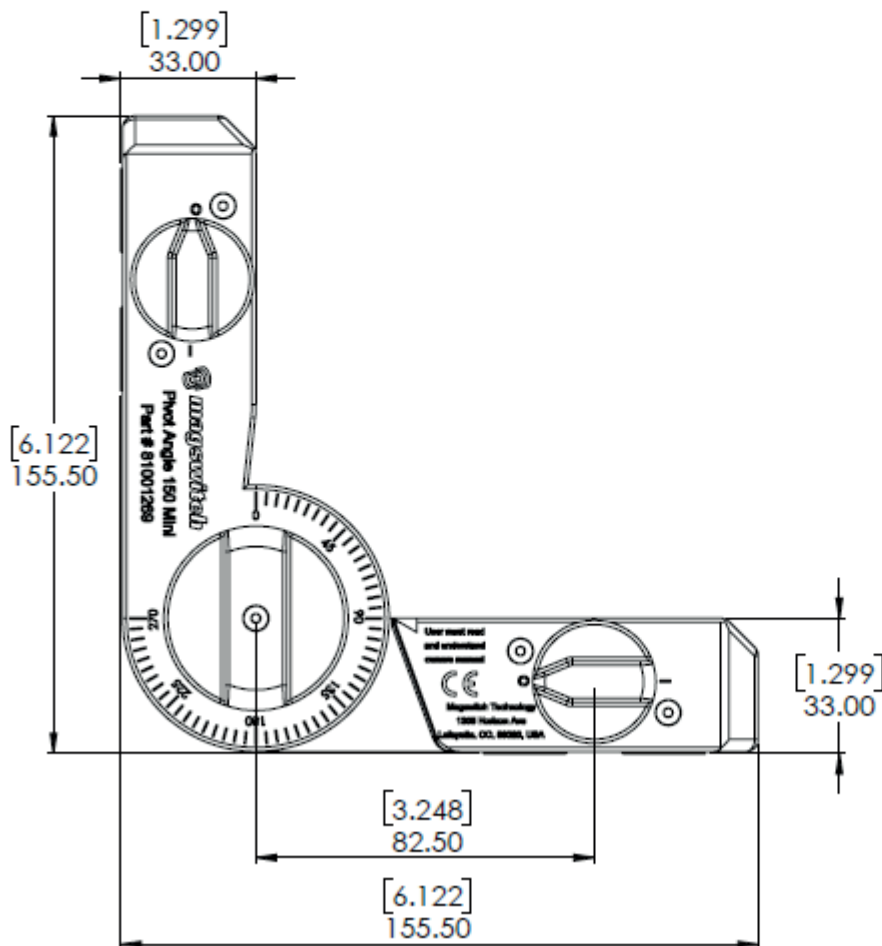
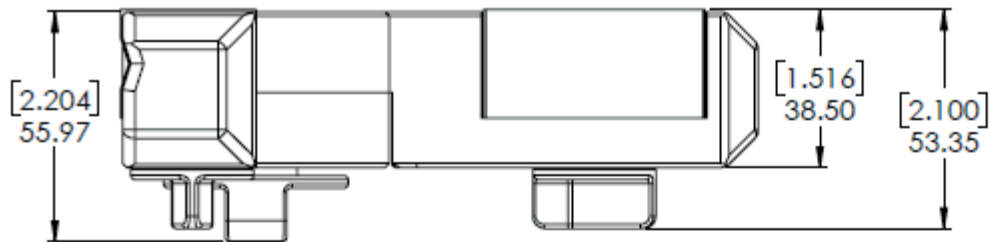

Pivot Angle 200

P/N: 8100367

Tool Features

The Magswitch Pivot Angle offers a range of angles from 28 to 270 degrees. Each arm features a Magswitch with a 200 lb (90kg) hold capacity. A single pivot point is located on the elbow. The elbow joint locks and unlocks quickly with a lever. The dial on the elbow features indicators every 9 degrees. On each axis a Magswitch is exposed on a side to enable the tool to secure to a table or wall, while simultaneously holding the work piece. Perfect for repetitive work on uncommon angles.



WARNING!
DO NOT OPERATE UNLESS IN
CONTACT WITH FERROUS TARGET

Specifications

Maximum Breakaway Force ^{1,2}	215 lbs					98 kg				
Maximum Shear ^{1,2,4}	48 lbs					22 kg				
Full Saturation Thickness	3/16"					4.75 mm				
Overall Length	9.1"					230.0 mm				
Overall Width	3.9"					97.9 mm				
Overall Height (Max)	6.4"					163.5 mm				
Net Weight	1.8 lbs					0.8 kg				
Magnetic Pole Footprint	2.2" x 1.6"					56.0 mm x 41.3 mm				
Material Thickness - mm (in)	0.476 (0.019)	0.873 (0.034)	0.953 (0.038)	1.429 (0.056)	1.984 (0.078)	2.381 (0.094)	3.175 (0.125)	3.572 (0.141)	6.350 (0.250)	9.525 (0.375)
Maximum Force - kg (lbs)	5.3 (12)	14.7 (32)	18.0 (40)	33.4 (74)	43.1 (95)	45.5 (100)	68.0 (150)	82.9 (183)	89.5 (197)	86.8 (191)

1. Determined in laboratory environment on 2" thick SAE1018 Steel with surface roughness 63 micro inches with optimized pole shoes. Many factors contribute to the actual breakaway force and safe working load in each application. Consult a Magswitch Applications Engineer and test the Magswitch in each application before deployment.

2. All data applies to unit with flat pole shoes installed.

3. Determined with SAE1018 Steel L=200mm W=200mm.

4. Values may vary by +/- 5%.

5. Maximum forces listed above are not safe lifting forces. Designer must take into account safety factor when specifying tool. Magswitch recommends SWL = 5:1 for most applications.

Pivot Angle 200

P/N: 8100367

Drawings

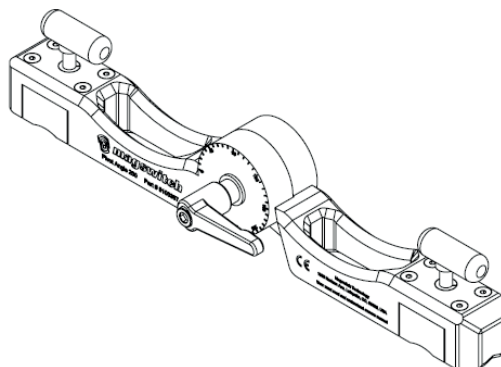
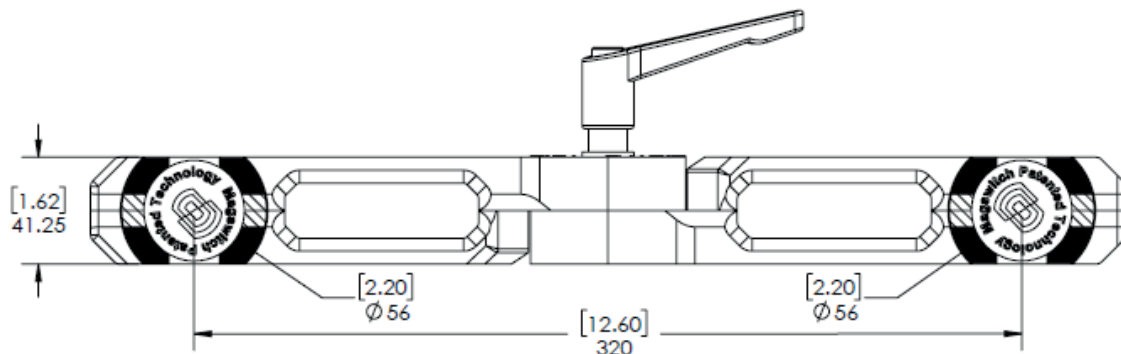
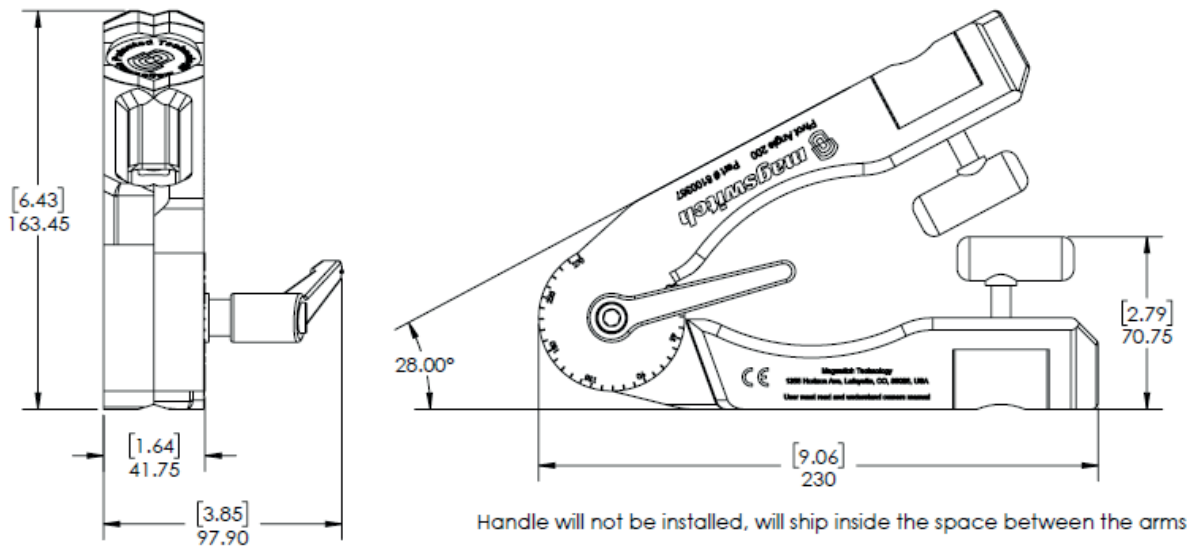

WORKING SURFACE
BLACK=BEST HATCHED=MODERATE